

amazon.com
 Shop now
 Privacy Information

arcspace.com

- Home
- Exhibitions
- The Bookcase
- The Architect's Studio
- The Camera
- Image Library
- Travel
- kk Letters
- Links

Features

Ads by Goooooogle

Jean Nouvel

Designs

Stainless Steel

Mugs, Flatware,

etc Free Ship!

28,000 Modern

Items.

[Unicahome.com/Jean-](http://Unicahome.com/Jean-Nouvel)

[Nouvel](http://Unicahome.com/Jean-Nouvel)

[new york](#)

[architects](#)

modern

architecture

dynamic and

comfortable

wcarchitect.com

[AB Design](#)

[Studio, Inc.](#)

full service

architecture+design

Ateliers Jean Nouvel

100 11th Avenue

New York, NY

"The design captures and celebrates the incredible light, air and urban fabric of Manhattan's industrial waterfront."

Craig Wood



Photo courtesy Ateliers Jean Nouvel

Construction has begun on the 23-story tower, described by Nouvel as "a vision machine," at the intersection of 19th Street and the West Side Highway, along the Hudson River in Manhattan. The glass and steel building is a direct material and conceptual descendant of Nouvel's 1987 Headquarters for the Arab World Institute in Paris.

- [Alvar Aalto](#)
- [Raimund Abraham](#)
- [Allied Works](#)
- [Alsop Architects](#)
- [Amoretti & Calvi](#)
- [Architetti](#)
- [Tadao Ando](#)
- [Paul Andreu](#)
- [Jun Aoki](#)
- [Asymptote](#)
- [Arquitectonica](#)
- [Shigeru Ban](#)
- [Luis Barragán](#)
- [Benson & Forsyth](#)
- [Berger + Parkkinen](#)
- [Cécile Brisac & Edgar Gonzalez](#)
- [Santiago Calatrava](#)
- [Coop Himmelb\(l\)au](#)
- [Le Corbusier](#)
- [Cruz & Ortiz](#)
- [Architect](#)
- [Diller + Scofidio](#)
- [Edge \(HK\) Ltd.](#)
- [Eisenman Architects](#)
- [Arthur Erickson](#)
- [Ralph Erskine](#)
- [Frederick Fisher and Partners](#)
- [Mark Fisher](#)
- [Foreign Office Architects](#)
- [Foster Partners](#)
- [Massimiliano Fuksas](#)
- [Frank O. Gehry](#)
- [Gluckman Mayner](#)
- [Michael Graves](#)
- [Nicholas Grimshaw and Partner](#)
- [Gwathmey Siegel & Ass.](#)
- [Zaha Hadid](#)

from conception to
construction

www.aurellblumer.com

Residential



Photo © [ArchPartners](#)

The main south curtain wall is comprised of approximately 1,647 completely different colorless windowpanes organized within enormous steel-framed "megapanel" that range from 11 to 16 feet tall and as wide as 37 feet across. Each windowpane inside these megapanel is tilted at a different angle and in a different direction – up, down, in, out - bearing a slightly different degree of transparency.



Rendering © [dbox](#)

- [T.R. Hamzah & Yeang](#)
- [Hardy Holzman Pfeiffer Associates](#)
- [Zvi Hecker](#)
- [Herzog & de Meuron](#)
- [Hodgetts + Fung](#)
- [Steven Holl](#)
- [Hans Hollein](#)
- [Arata Isozaki & Associates](#)
- [Toyo Ito](#)
- [Jacob + MacFarlane](#)
- [Arne Jacobsen](#)
- [Philip Johnson](#)
- [KHR AS](#)
- [Josef Paul Kleihues](#)
- [Rem Koolhaas OMA](#)
- [Leon Krier](#)
- [Kisho Kurokawa](#)
- [LAB architecture studio](#)
- [Henning Larsen](#)
- [John Lautner](#)
- [Legorreta + Legorreta](#)
- [Daniel Libeskind](#)
- [Maya Lin](#)
- [Søren Robert Lund](#)
- [Lunde & Løvseth](#)
- [Lundgaard & Tranberg](#)
- [Machado and Silveti](#)
- [Michael Maltzan](#)
- [Dorte Mandrup Architects](#)
- [Mecanoo Architects](#)
- [Vlado Milunic](#)
- [Richard Meier](#)
- [EMBT](#)
- [Moore, Ruble & Yudell](#)
- [Jose Rafael Moneo](#)
- [Morphosis](#)
- [Eric Owen Moss](#)
- [Glenn Murcutt](#)
- [MRVDV](#)
- [Erik Møllers](#)
- [3xN](#)
- [Oscar Niemeyer](#)
- [Jean Nouvel](#)
- [NOX](#)
- [Office dA, Inc](#)
- [Palladio](#)
- [Verner Panton](#)
- [Pelli Clarke Pelli](#)
- [Dominique Perrault](#)
- [Renzo Piano](#)
- [Workshop](#)
- [PLOT](#)
- [Polshak Partnership Architects](#)
- [Antoine Predock](#)
- [PTW](#)
- [Richard Rogers](#)
- [Rojkind Arquitectos](#)
- [Aldo Rossi](#)
- [RoTo Architects, Inc.](#)
- [SANAA](#)
- [Moshe Safdie](#)
- [Saucier + Perrotte](#)

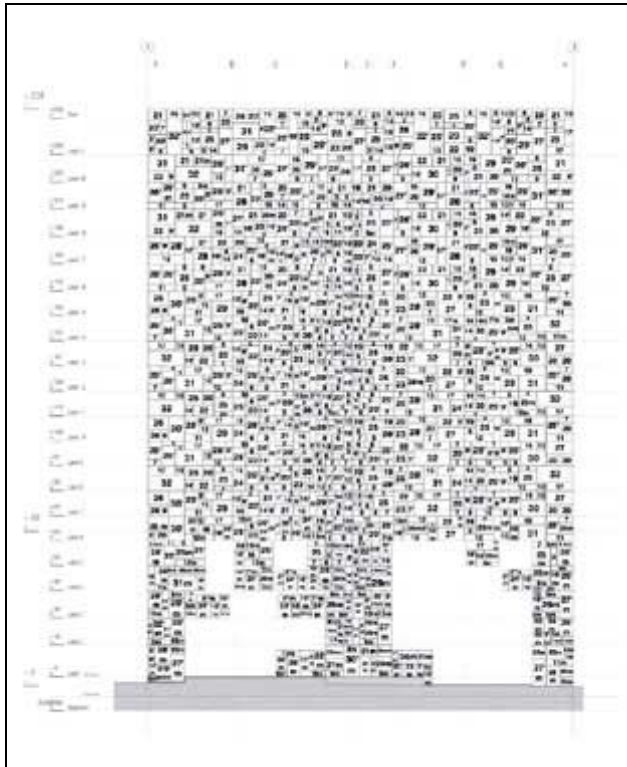

Image courtesy Ateliers Jean Nouvel
Study for the mosaic-like curtain wall.

By contrast, the north and east facades will be clad in black brick that references the masonry characteristic of West Chelsea’s industrial architecture. These facades will also contain a complex pattern of different-sized punched windows framing dramatic views from inside.

A seven story free-standing “screen” of densely mullioned glass, a near repeat of the main facade’s steel-framed mosaic pattern, is placed 15 feet from the building’s south facade. The space created between the tower’s multifaceted glass curtain wall and this street wall screen forms a semi-enclosed atrium, called “The Loggia.” Within this atrium fully-grown trees and beds of ornamental plantings, placed within the grid, will appear to float in mid-air.

- [K. M. Schindler](#)
- [Schmidt, Hammer & Lassen](#)
- [Alvaro Siza](#)
- [Skidmore, Owings & Merrill](#)
- [Snøhetta](#)
- [Souto de Moura](#)
- [Spacelab](#)
- [Phillipe Starck](#)
- [Studio Granda](#)
- [Yoshio Taniguchi](#)
- [TEN Arquitectos](#)
- [Tetreault Dubuc](#)
- [Saia et associes](#)
- [Bernard Tschumi](#)
- [UNStudio](#)
- [Utzon Architects](#)
- [Venturi, Scott Brown & Ass.](#)
- [VIIVA arkkitehtuuri](#)
- [Rafael Viñoly](#)
- [Vinnustofa Arkitekta](#)
- [Allmann Sattler Wappner](#)
- [Weiss/Manfredi](#)
- [Ellis Williams Architects](#)
- [Tod Williams Billie Tsien](#)
- [Gert Wingårdh](#)
- [René van Zuuk](#)



Image courtesy Ateliers Jean Nouvel

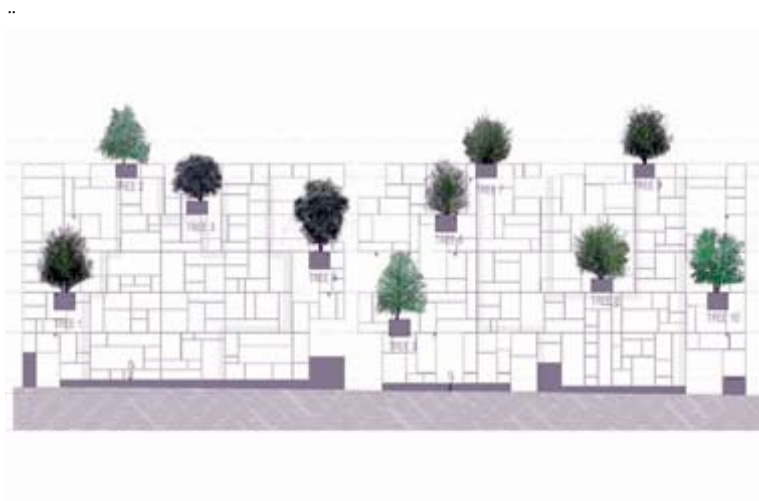

Rendering courtesy Ateliers Jean Nouvel

At 70 feet long, the building's mirror-canopied pool will be one of the longest in Manhattan. The majority of the pool is sheltered within the building's structure, with 24 feet extending into a landscaped outdoor space (the lower tier of the garden).

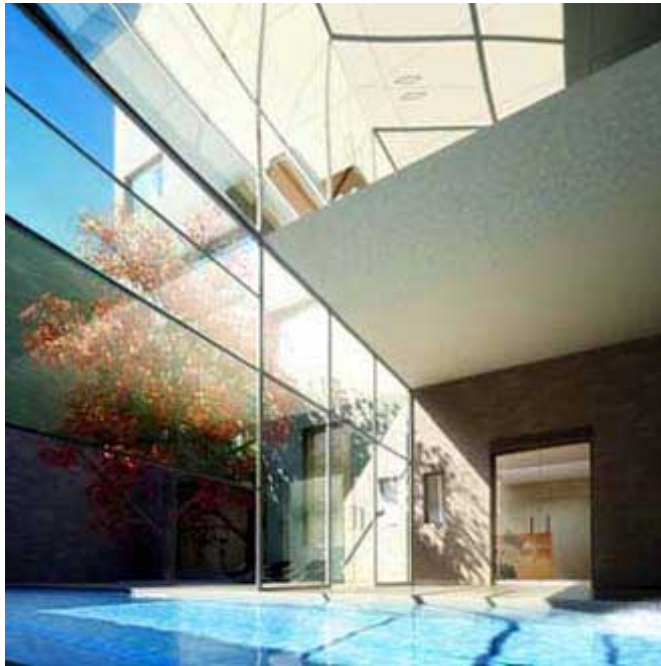

Image courtesy Ateliers Jean Nouvel

View looking down onto the two-tiered private garden with section of the swimming pool protruding at lower level.

photo8



Rendering courtesy Atelier Jean Nouvel

In the 20 foot-high ceiling lobby enormous, single-pane punched windows of different textures and degrees of transparency will face the building's private multitiered slope garden on the north side of the building, bringing nature indoors.



Image courtesy Ateliers Jean Nouvel

The palette of apartment interiors is pale and materials have been chosen to achieve maximum luminosity, with an overall look inspired by the sleek minimalism of the neighborhood's many contemporary art galleries.



Photo © [dbox](#)



Photo © [dbox](#)

Elevator shafts will contain random LED lighting and full-scale punched windows, so that passengers in glass-walled cabs can see city vistas as they ascend at 450 feet per minute, while twinkling light patterns are visible from elsewhere in the neighborhood.

The building will contain 72 residences and be LEED certified.

Estimated completion: Fall 2008

Architect: [Atelier Jean Nouvel](#)

Executive architects:

[Beyer Blinder Belle Architects & Planners, LLP](#)

Partner in charge: John H. Beyer

Developer: [Cape Advisors Inc](#)/Craig Wood

Associate developer: Alf Naman Real Estate Advisors

General contractor: Gotham Construction Corporation, Inc.

[Ateliers Jean Nouvel](#) arcspace features

April 2, 2007

[Home](#) | [Exhibitions](#) | [The Bookcase](#) | [The Architect's Studio](#) | [The Camera](#) | [Image Library](#) | [Travel](#) | [kk Letters](#) | [Links](#)

[about arcspace](#)

copyright 1999 - 2007 arcspace all rights reserved.
comments or questions? - [Publisher Kirsten Kiser](#)